

# C7 CARBON

## C8 Z07 CORVETTE I High Wing for Z06

Please fully read all the steps before proceeding to install.

### Content:

- A. Wing Blade
- B. Wing Stand Covers
- C. Back Bone
- D. Wing Blade Bracket
- E. Upright
- F. Tie Bar
- G. Upright Stand
- H. Tub Bracket
- I. Spacers
- J. Crash Bar Brackets
- K. 3D Printed Clips

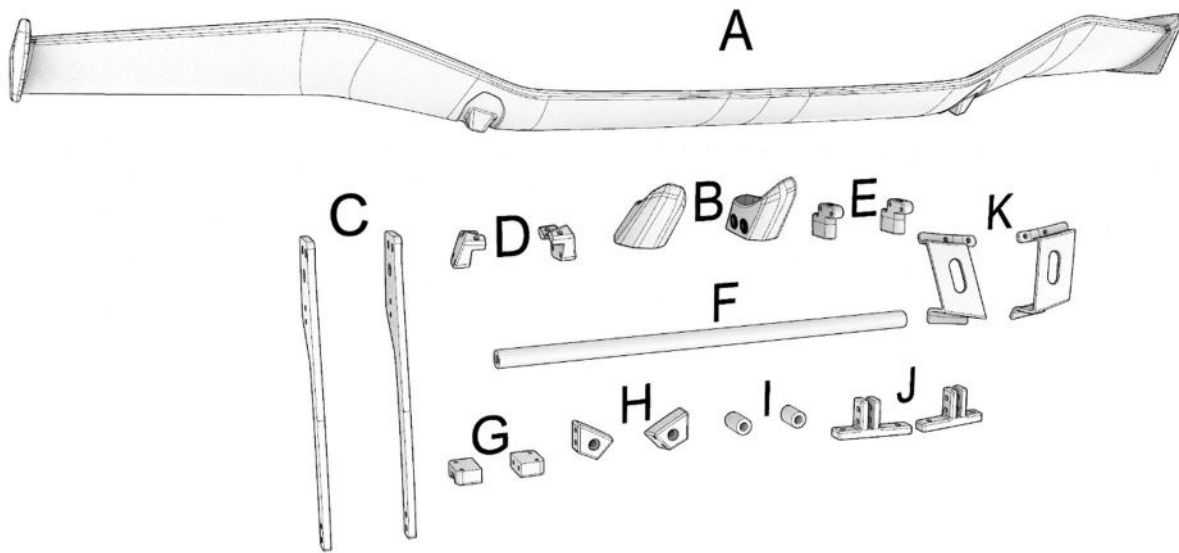

### Bracket Bolt Size:

- 1. M8 x 110
- 2. M8 x 50
- 3. 1/4 x 1.5
- 4. M10 x 80
- 5. 9/16-12 x 1.5
- 6. M6 x 40
- 7. M6 x 60

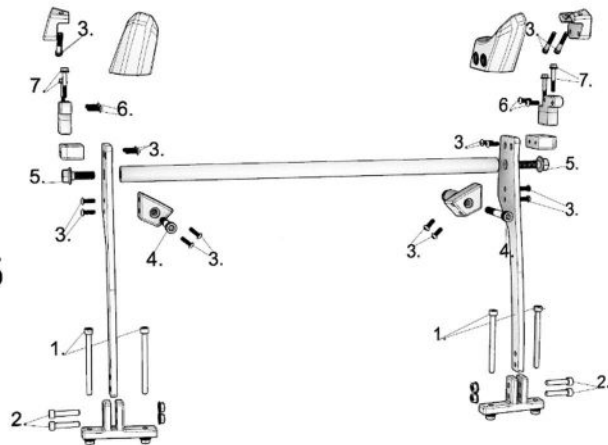

## Install Instructions.

### Step 1: REMOVE THE BUMPER COVER

1

- Open the rear hatch/rear trunk.
- Remove the 16 screws on top of the Bumper (14 Screws + 2 corner screws).

**Note:** We recommend an organizer for all the screws.

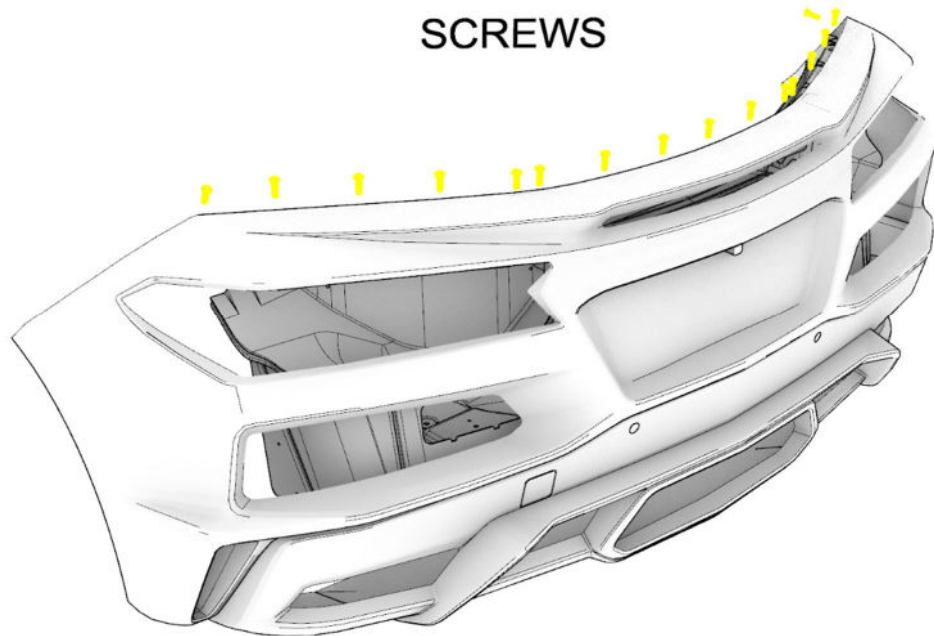
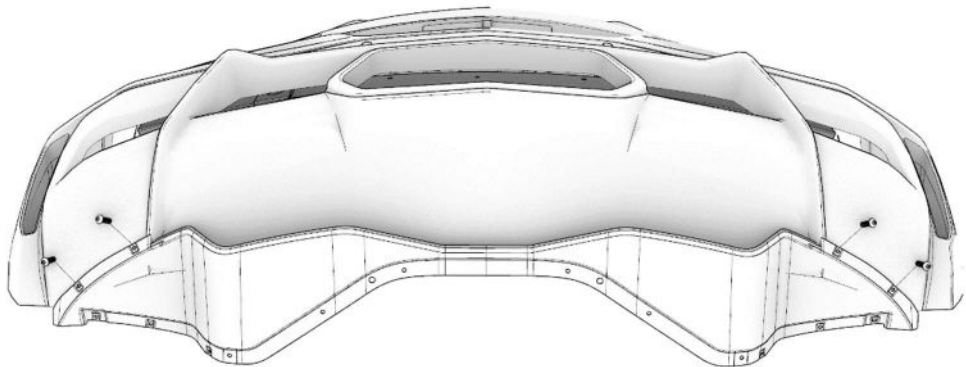

Figure 1 – Top Bumper

2

- On the lower section of the bumper, remove 2 screws on the left side and 2 on the right side.



SCREWS

Figure 2 – Bottom Bumper

# 3

·Remove the mud flap guard by simply pulling it (Left and Right side).

·Remove the screws on the back of the fender liner, two on the side and one on the top. (Left and Right side).

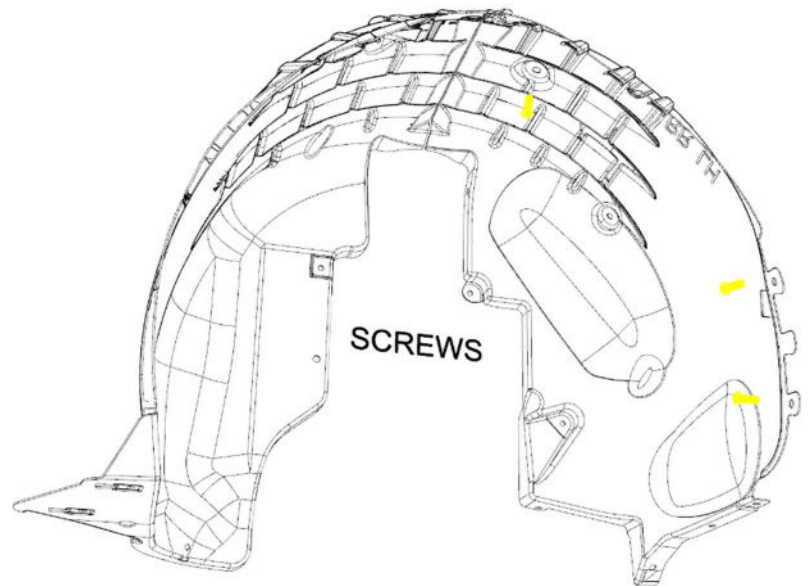

Figure 3 – Fender Liner

# 4

·Flex the fender liner to remove two 7mm screws and a 10mm nut connecting the bumper to the sides (left and right side).

·Before removing the rear bumper completely, be sure to disconnect the taillight connectors.

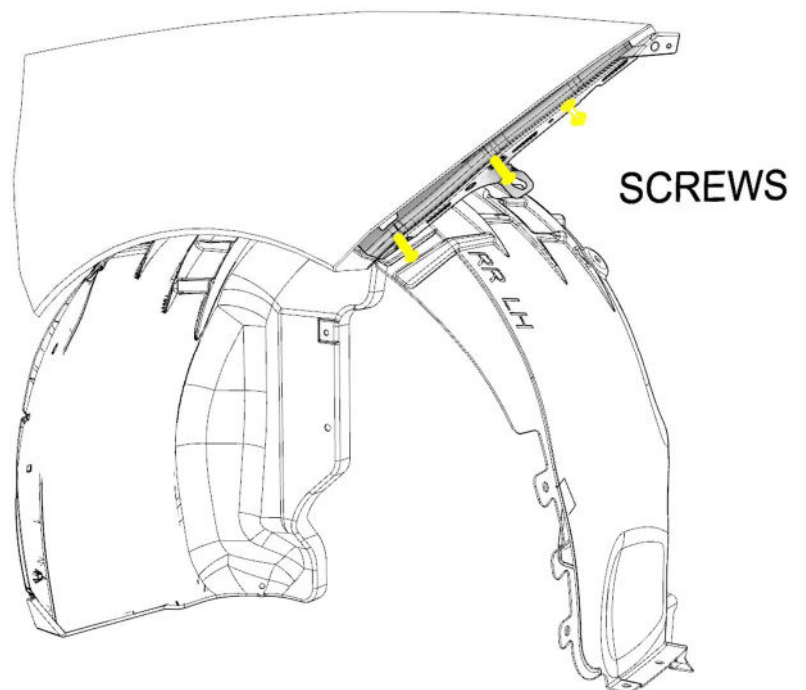

Figure 4 – Side Connection Bumper

## Step 2: INSTALL THE CHASSIS MOUNT FOR THE WING

5

- Remove the retainer for the wiring in the Crash Bar.
- Assemble the Chassis Mount for the Spoiler as shown in the diagram without fully tightening the bolts.

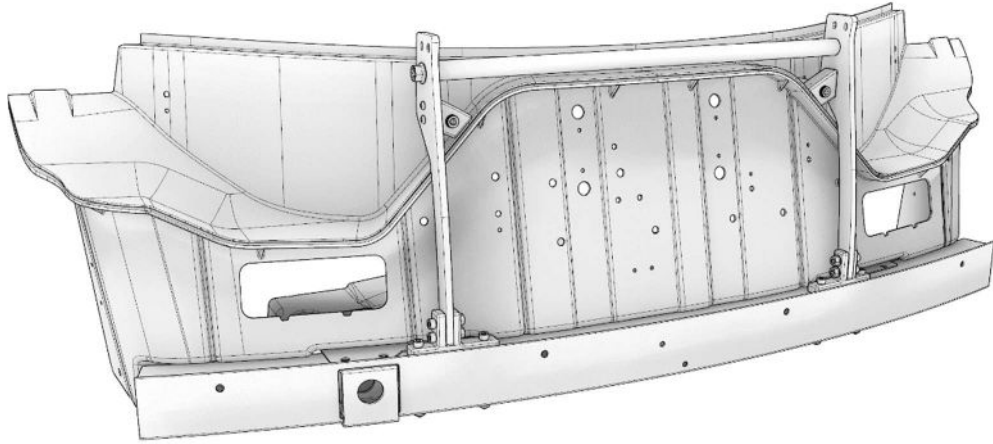

Figure 5 – Chassi Mounts Diagram

6

- To locate the first mounting point, place the assembled chassis mount on top of the carbon fiber crash beam.
- The second mounting point is located on top of the seam of the SMC rear tub.
- Mark the position, drill the holes for the bolts and assemble as shown in the diagram.

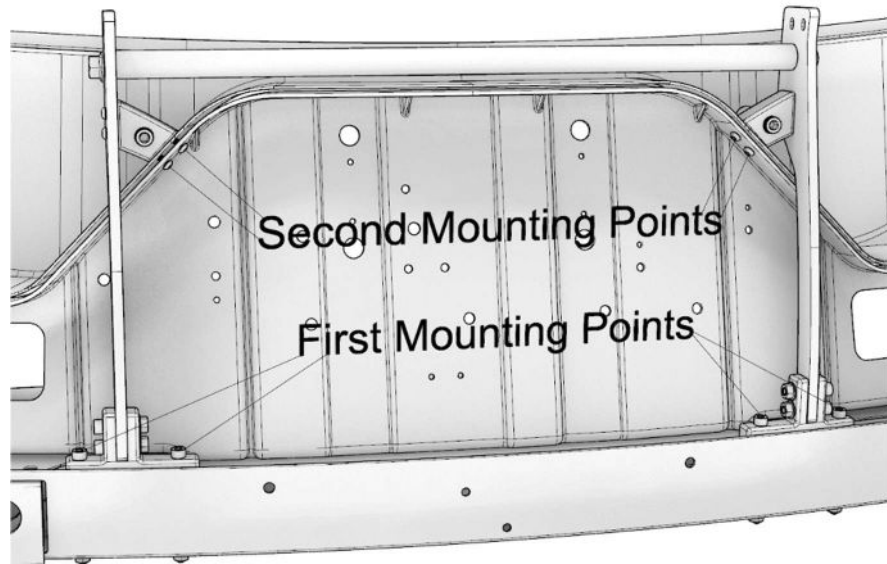

Figure 6 – Mounting Points Diagram

7

- Place the aluminum spacer and now you can tighten everything completely.

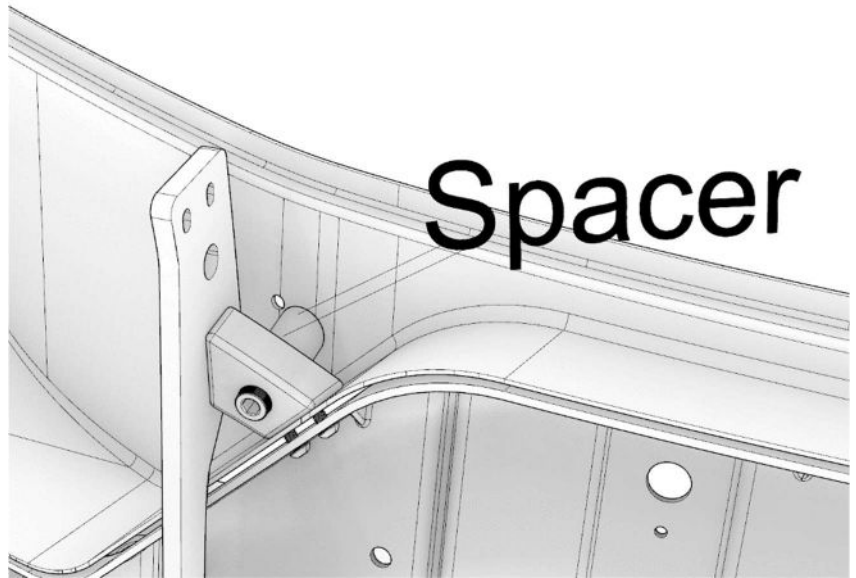

Figure 7 – Spacer Position

8

- Place the Tie Bar (F), Upright Stand (G) and Upright (E).
- Reinstall the wiring retainer into the protection bar, this step requires some cutting into the retainer.

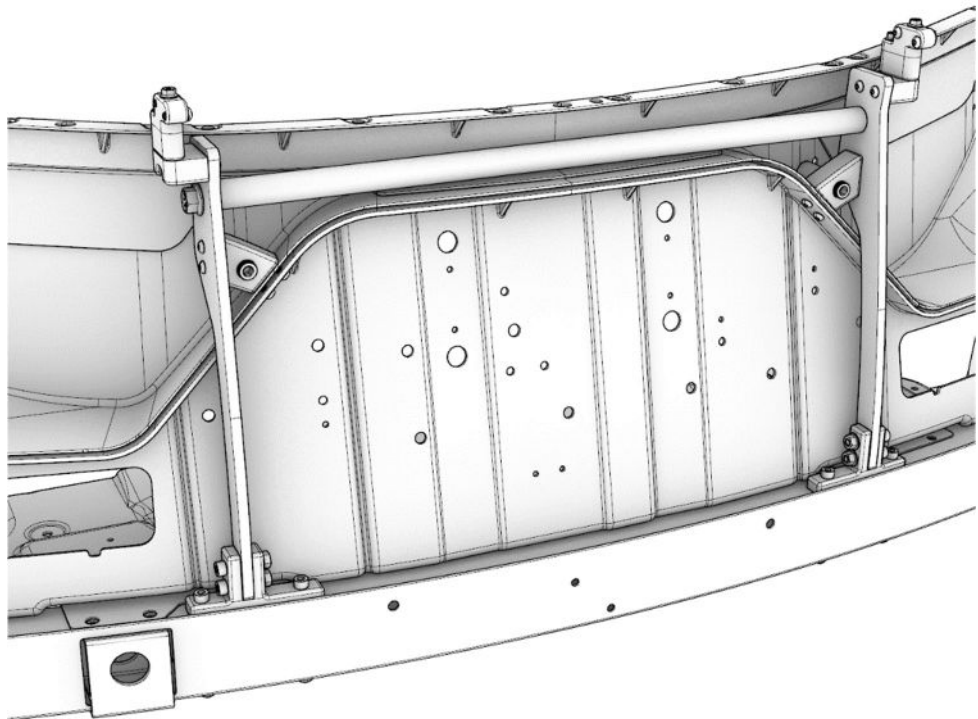
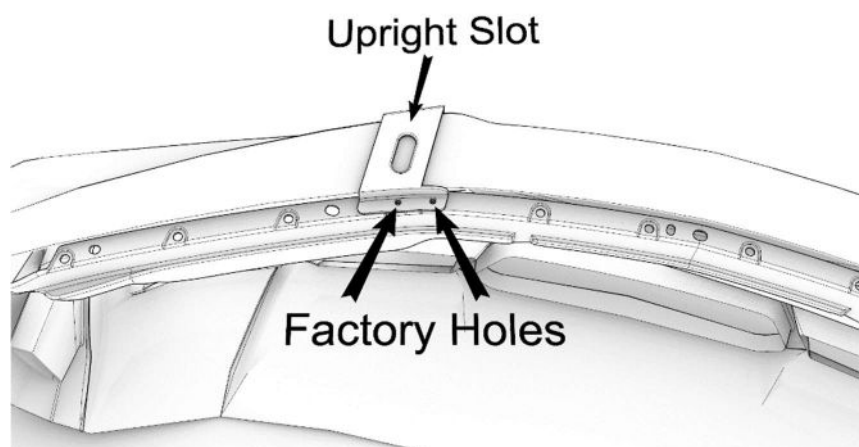
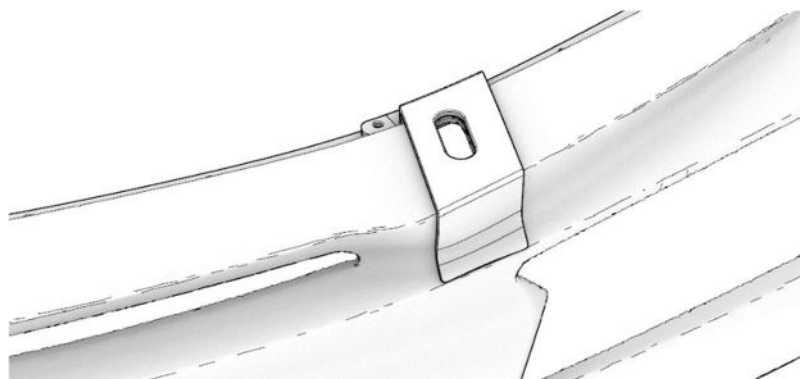

Figure 8 –Chassi Mounts Diagram

**Step 3: INSTALL THE REAR BUMPER AND MOUNT THE WING BLADE.**

Place the 3D printed clips on the rear bumper and match the bracket holes to the factory holes as shown in the diagram to make the upright slots.



*Figure 9/10 – 3D Clips Position*

Assemble the Rear Bumper following the steps of the first module.

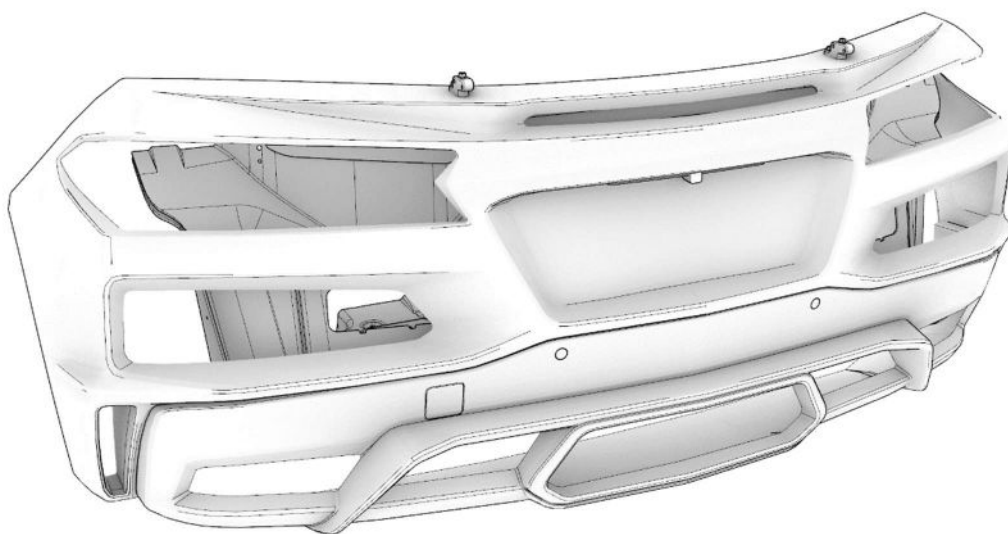

*Figure 11 –Rear Bumper Position*

1  
1

- Mount the Wing Blade Brackets on the bottom of the wing.

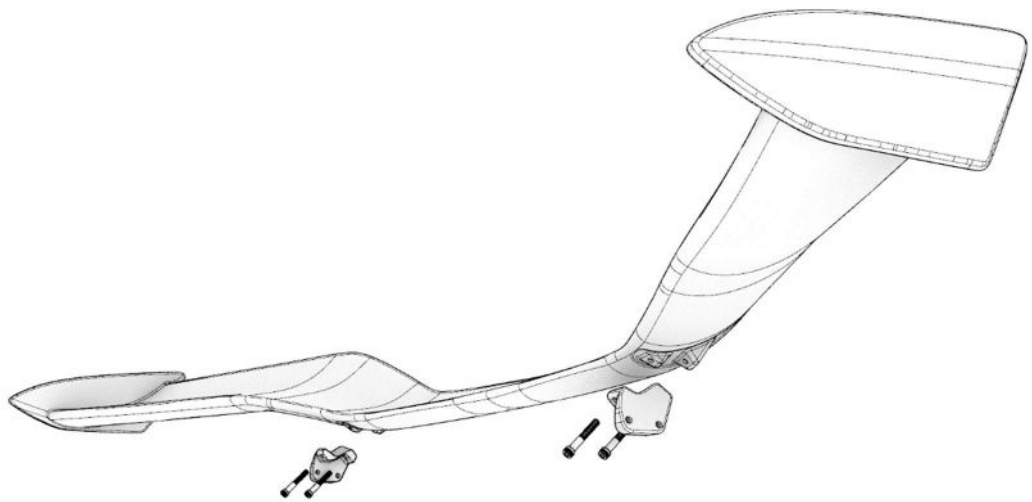

Figure 12 –Blade Brackets Diagram

1  
2

- Place the Wing Stand Covers, mount the Wing Blade on top, then secure it with side screws to finish the installation.

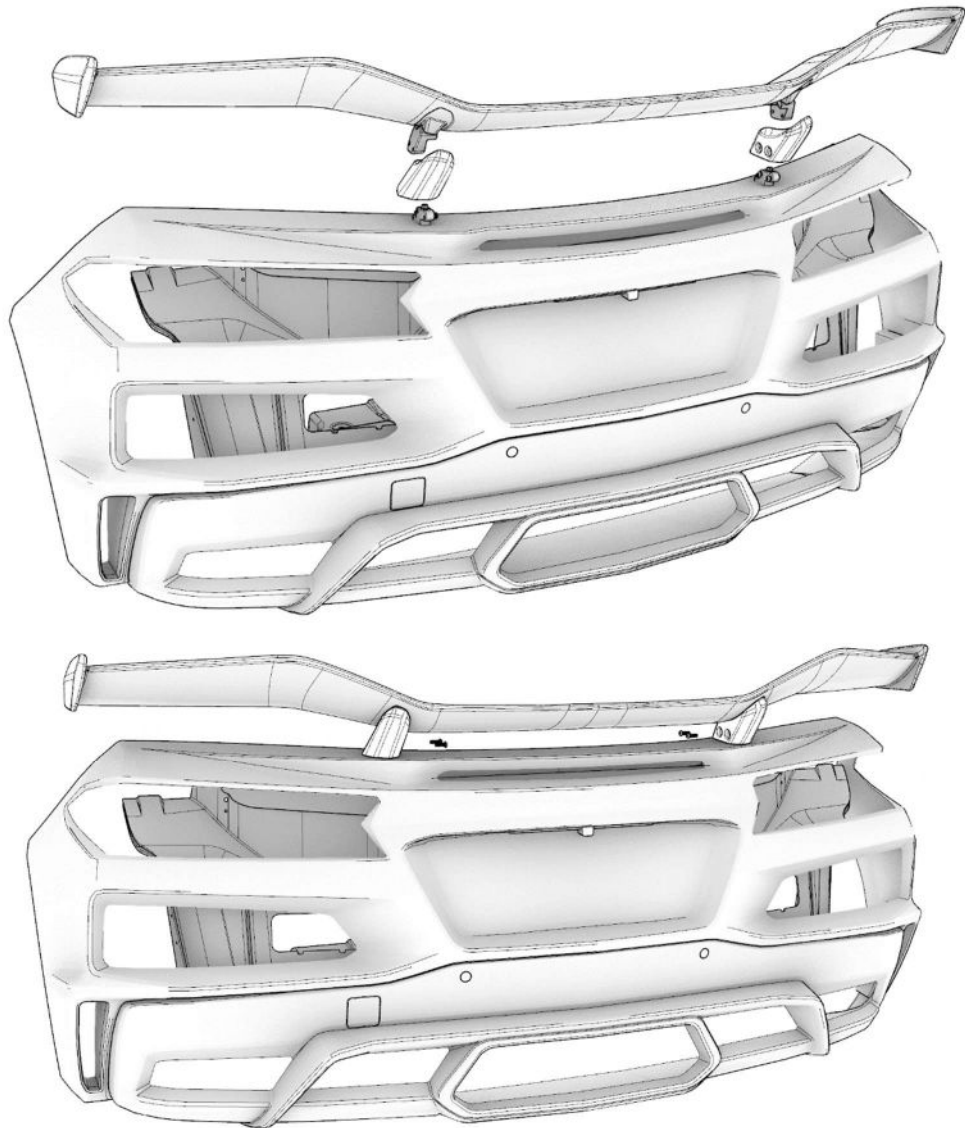
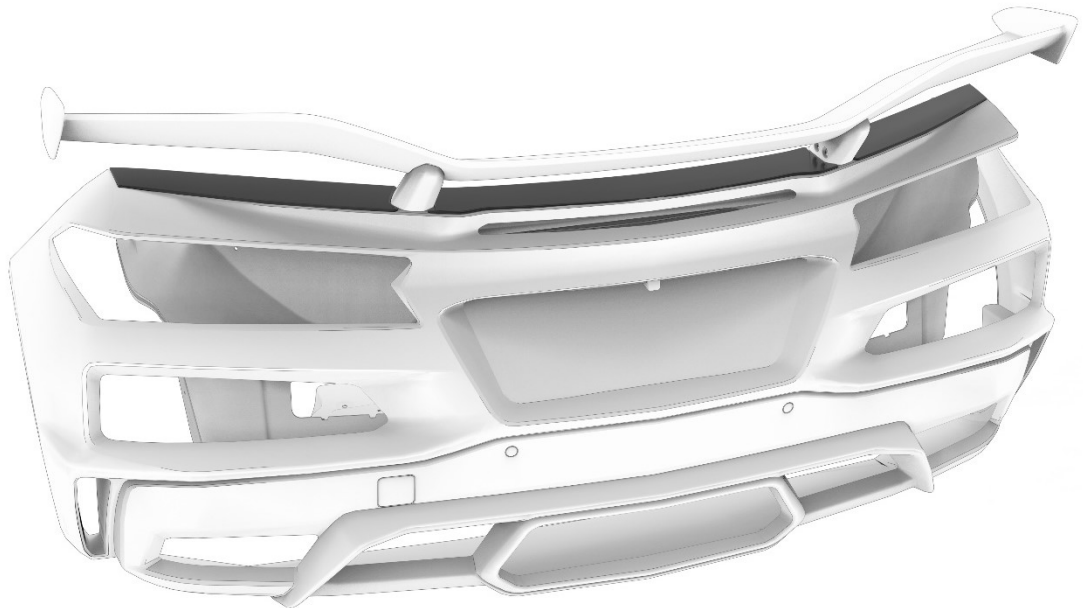

Figure 13/14 – Wing Blade Mount

Also Available.

1  
3

Hole Delete Plate Covers  
(Sold Separately)



*Figure 15/16 – Hole Delete Plate Covers  
(Sold Separately)*